



Republic of the Philippines

**ANGELES CITY WATER DISTRICT**

Pampang Road, Brgy. Lourdes Northwest, Angeles City

(045) 458-0384; (045) 458-0382; (045) 458-0372

(045)322-6422; (045)458-0371, Fax No.: (045)322-6926

E-mail address: [angelescitywvd@gmail.com](mailto:angelescitywvd@gmail.com)

Website: <http://www.angelescitywvd.gov.ph/>

Date Prepared: June 29, 2020  
Date Approved: June 29, 2020  
Effectivity Date: June 29, 2020  
Control No.: BAC-06-29-2020-01

Revision: 01

Revision Date: 02/16/19

Page 1 of 1

**SUPPLEMENTAL/BID BULLETIN  
ADDENDUM NO. 01**

**Title of Project:** SUPPLY OF LABOR AND MATERIALS FOR THE CONSTRUCTION OF PROPOSED WATERLINE EXTENSION AT BARANGAY CUTUD, ANGELES CITY

This Addendum No. 01 is issued to modify, amend and add items in the Bid Documents. This shall form an integral part of the Bidding Documents:

- Addition to Section VI: TECHNICAL SPECIFICATION: see attached documents

For guidance and information of all concerned.

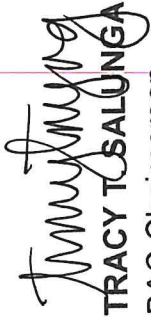
  
**TRACY T. SALUNGA**

BAC Chairperson

Received by the Bidder

Name: \_\_\_\_\_

Date: \_\_\_\_\_

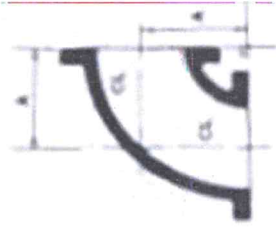

Flanged Elbow 90°

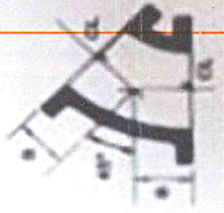

Flanged Elbow 45°

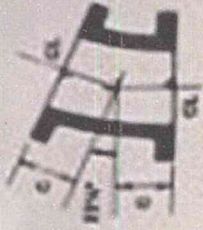

Flanged Elbow 22.5°



Flanged Elbow 11.25°

NOMINAL SIZE	A	NOMINAL SIZE	B	NOMINAL SIZE	C	NOMINAL SIZE	D
50 x 90°	114.5	50 x 45°	63.5	50 x 22.5°	63.5	50 x 11.25°	63.5
63 x 90°	127	63 x 45°	75	63 x 22.5°	75	63 x 11.25°	75
75 x 90°	149.5	75 x 45°	76	75 x 22.5°	76	75 x 11.25°	76
100 x 90°	165	100 x 45°	101.5	100 x 22.5°	101.5	100 x 11.25°	101.5
150 x 90°	203	150 x 45°	127	150 x 22.5°	127	150 x 11.25°	127
200 x 90°	226.5	200 x 45°	140	200 x 22.5°	140	200 x 11.25°	140
250 x 90°	279.5	250 x 45°	165	250 x 22.5°	165	250 x 11.25°	165
300 x 90°	304.5	300 x 45°	190.5	300 x 22.5°	190.5	300 x 11.25°	190.5

**Notes:**

1. All dimensions are in millimeter except degree of bend.
2. Cast iron material shall conform with ASTM A126 class B.
3. Exterior shall be painted with black enamel.
4. Interior surface shall be cement lined as per AWWA C-104.

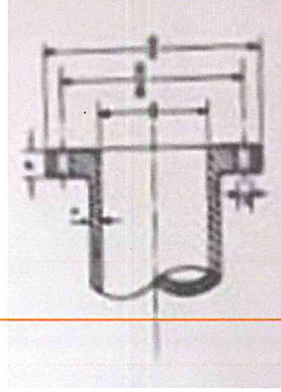

NOMINAL SIZE	FLANGE DIMENSION						FLANGE HOLE	
	OD	BCD	ID	F	T	Ø	Ng	
50	165	125	50	15	8	16	4	
63	185	145	63	18	10	16	4	
75	200	150	75	19	12	16	8	
100	220	180	100	22	13	16	8	
150	285	240	150	25	14	19	8	
200	340	295	200	27	16	19	8	
250	405	355	250	30	17.5	19	12	
300	460	410	300	32	19	19	12	

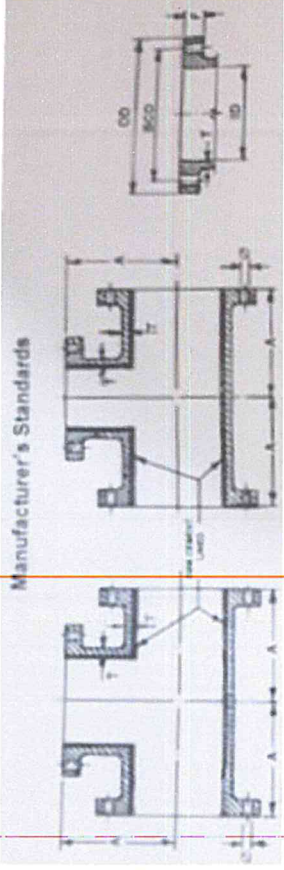

FULL SECTION VIEW OF CAST IRON  
FLANGED STRAIGHT TEE

FULL SECTION VIEW OF CAST IRON  
FLANGED REDUCING TEE

FLANGED DETAIL

STRAIGHT TEE		REDUCING TEE			
NOMINAL SIZE	A	NOMINAL SIZE	A	NOMINAL SIZE	A
50 x 50	127.0	63 x 50	140.0	200 x 100	254.0
63 x 63	140.0	75 x 50	152.4	200 x 150	254.0
75 x 75	152.4	75 x 63	152.4	250 x 100	292.0
100 x 100	178.0	100 x 50	178.0	250 x 150	292.0
150 x 150	203.0	100 x 75	178.0	250 x 200	292.0
200 x 200	254.0	150 x 75	203.0	300 x 150	330.0
250 x 250	292.0	150 x 100	203.0	300 x 200	330.0
300 x 300	330.0	200 x 75	254.0	300 x 250	330.0

NOMINAL SIZE	FLANGE DIMENSION						FLANGE HOLE	
	OD	ID	BCD	F	T	Ng	Ø	
50	165.0	50.0	125.0	15.0	9.5	4	19.05	
63	185.0	63.0	145.0	17.5	11.0	4	19.05	
75	200.0	75.0	150.0	19.0	12.7	8	19.05	
100	220.0	100.0	180.0	23.9	14.3	8	19.05	
150	285.0	150.0	240.0	25.4	16.0	8	22.22	
200	340.0	200.0	295.0	28.6	17.5	8	22.22	
250	405.0	250.0	355.0	30.2	18.0	12	25.40	
300	460.0	300.0	410.0	31.8	19.0	12	25.40	

Notes:

1. All dimensions are in millimeters.
2. Cast iron material shall conform with ASTM A48 class 35 C standards.
3. Rubber gasket are made from natural vulcanized rubber, which conforms to ISO-4633 class 70 standards and is subtle for contact with drinking water.
4. Bolts and nuts conforms to ASTM A307 and ASPM A563, respectfully. Galvanized in accordance with ASTM A153.
5. Exterior coated with a coal-tar enamel at least 50 microns thick.
6. All surfaces directly in contact with the pipe and rubber ring have either been machine finished or ground smooth.
7. Pipe or fitting marking shall include:
  1. Name of manufacturer
  2. Size
  3. Year manufactured
  4. Cast iron
8. Rubber markings include:
  1. Type
  2. Size of intended use
  3. Name of manufacturer
9. Interior is lined with cement conforming to AWWA C-104 standards.
10. Fitting dimensions shall conform with AWWA C-110 standards.
11. Flange dimensions shall conform with ISO 7005-2 PN16 standards.
12. Other dimensions shall conform with the manufacturer's standards.